

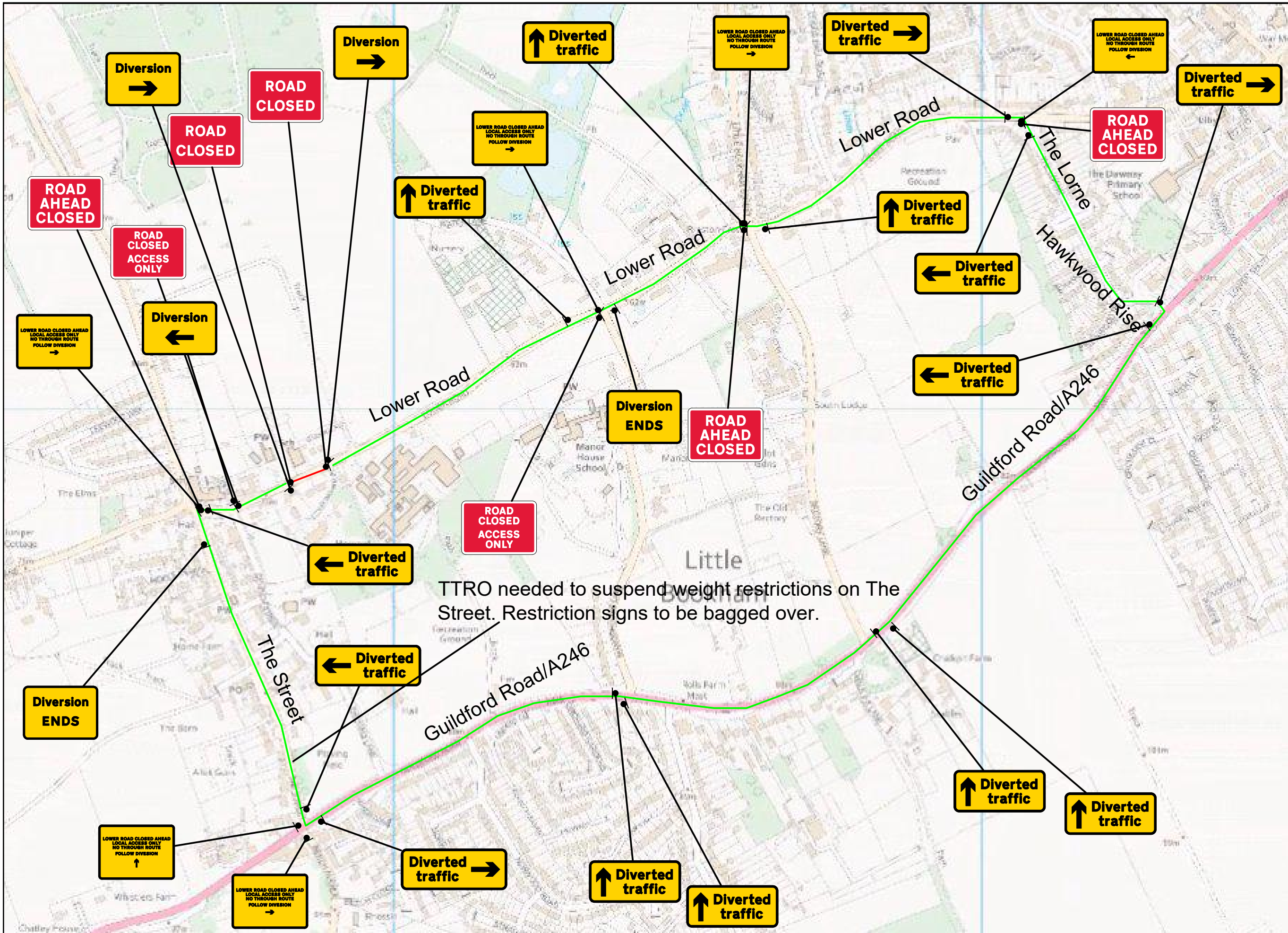

Not To Scale.  
Drawn by G.T



- Notes:
1. All Traffic Management will be set out in accordance with the traffic signs manual, chapter 8, 2009.
  2. Any sign reference numbers used in this drawing refer to either the diagram numbers contained within the traffic signs regulations and general directions (TSRGD)2016
  3. All signage will be fully installed before the closure is brought into effect.
  4. All sign frames will be secured with sand bags.
  5. Exact locations of signs are to be determined on site and will be positioned as to not obstruct any other sign, footpath or visibility.
  6. The inner boundary of the safety zone is omitted for clarity but is to be marked with barriers in accordance with TSM Chapter 8 at the appropriate distance for the speed of carriageway.

Road Closed  
 Diversion Route

Lower Road closed, diversion via;  
 Lower Road, The Street, Guildford Road/A246, Hawkwood Rise, The Lorne, Lower Road & vice versa